

# dji RSC 2

## User Manual v1.0

2020.10

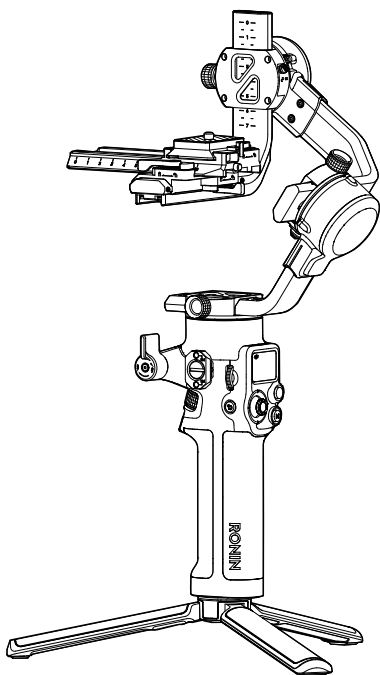

## **Searching for Keywords**

Search for keywords such as “battery” and “install” to find a topic. If you are using Adobe Acrobat Reader to read this document, press Ctrl+F on Windows or Command+F on Mac to begin a search.

## **Navigating to a Topic**

View a complete list of topics in the table of contents. Click on a topic to navigate to that section.

## **Printing this Document**

This document supports high resolution printing.

# Using this Manual

## Legend



## Before You Begin

The following documents have been produced to help you safely operate and make full use of your DJI RSC 2.

DJI RSC 2 Quick Start Guide

DJI RSC 2 User Manual

DJI RSC 2 Disclaimer and Safety Guidelines

Read the entire quick start guide and user manual and watch the informational and tutorial videos on the product page on the DJI official website (<http://www.dji.com/rsc-2>). Read the disclaimer and safety guidelines to understand your legal rights and responsibilities. If you have any questions or problems during the installation, maintenance, or use of this product, contact DJI or a DJI authorized dealer.

## Download the Ronin App

Search “Ronin” in the App Store or Google Play and follow the instructions for installation.



iOS 11.0 or above



Android 7.0 or above



Ronin App

# Contents

<b>Using this Manual</b>	2
Legend	2
Before You Begin	2
Download the Ronin App	2
<b>Introduction</b>	4
DJI RSC 2 Diagram	5
<b>Getting Started</b>	6
Unfolding the Gimbal	6
Attaching the Extended Grip/Tripod	6
Unlocking and Locking the Gimbal	7
Mounting the Camera	7
Balancing	9
<b>Grip and Built-In Battery</b>	12
Charging	12
Safety Guidelines	12
<b>Operations</b>	16
Activating DJI RSC 2	16
Screen Operation	16
Ronin App Settings	19
Image Transmission	27
<b>Operation Modes</b>	28
<b>Updating Firmware</b>	29
<b>Specifications</b>	30
<b>Maintenance</b>	30

# Introduction

DJI RSC 2 is a professional single-handed 3-axis gimbal specifically designed for DSLR and mirrorless cameras. It is compatible with a wide range of camera setups and supports a tested payload of up to 3 kg. DJI RSC 2 boasts enhanced gimbal performance thanks to its updated Titan Stabilization Algorithm.

With a foldable design, DJI RSC 2 can be used in Briefcase mode without the need for other accessories and is easy to store. Locks on each axis arm enables faster and more convenient balancing as well as more secure storage. Users can calibrate the gimbal and set parameters on the screen and use the onboard buttons to control the gimbal and switch profiles and working modes. With the NATO ports, accessories such as the Twist Grip Dual Handle can be used. When used with the provided camera control cables, DJI RSC 2 can also control the camera focus, shutter, and recording. The grip has a built-in battery with a capacity of 3400 mAh, providing a maximum runtime of up to 14 hours\*.

After connecting to the Ronin app, it is easy to control gimbal movement and parameter settings with intelligent functions such as Panorama, Timelapse, and Track. With the DJI Ronin RavenEye Image Transmission System mounted, users can access the camera view and shoot smooth footage while automatically tracking a subject with ActiveTrack 3.0.

\* The runtime was tested with DJI RSC 2 well-balanced and without any accessories or camera control cables attached. The maximum runtime is for reference only.

## DJI RSC 2 Diagram

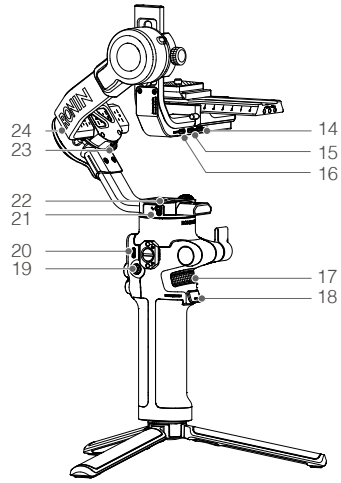
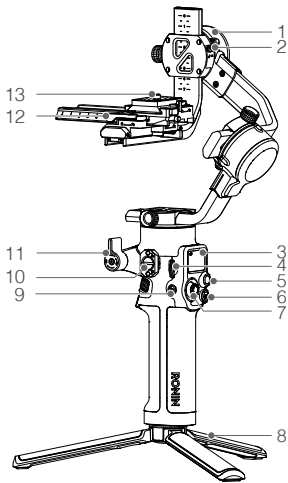

1. Tilt Motor
2. Tilt Lock
3. Screen
4. Side Dial
5. Camera Control Button
6. M Button
7. Joystick
8. Extended Grip/Tripod
9. Back Button
10. M4/NATO Port
11. Lock Knob
12. Lower Quick-Release Plate
13. Upper Quick-Release Plate

14. Image Transmission/Focus Motor Port (USB-C)
15. Focus Motor Port (USB-C)
16. RSS Camera Control Port (USB-C)
17. Front Dial
18. Trigger
19. Power Button
20. Power Port (USB-C)
21. Pan Lock
22. Pan Motor
23. Roll Lock
24. Roll Motor

# Getting Started

## Unfolding the Gimbal

Loosen the lock knob to the unlocked position, unfold the gimbal as shown, and tighten the lock knob to the locked position.

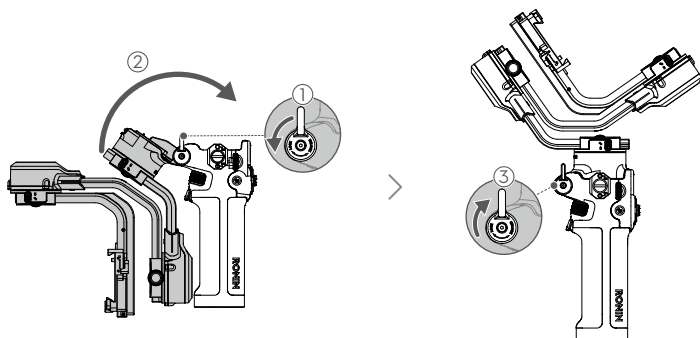

## Attaching the Extended Grip/Tripod

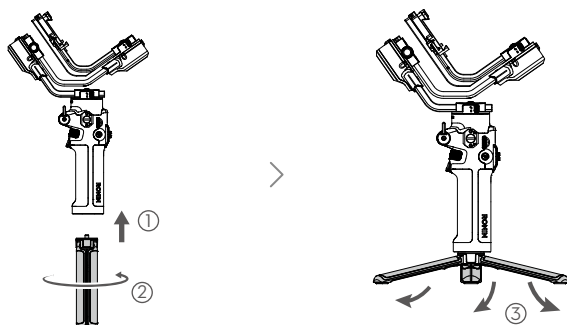

## Unlocking and Locking the Gimbal

To unlock the gimbal, toggle the tilt, roll, and pan lock levers to the unlocked position. Adjust the gimbal position as shown and toggle the three locks to the locked position.

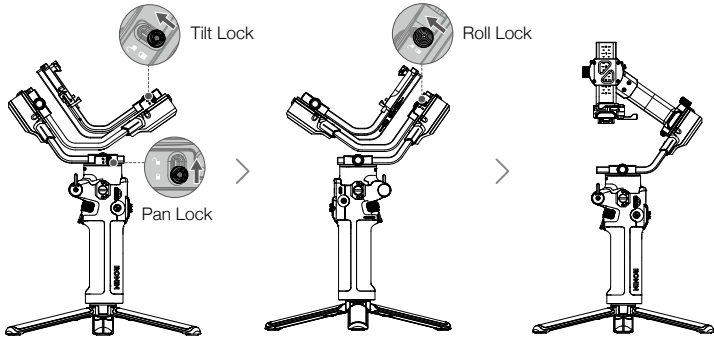

## Mounting the Camera

### Supported Cameras and Lenses

DJI RSC 2 has been rigorously tested to support a payload of 3 kg. Make sure the combined weight of the camera, lens, and other accessories are within 3 kg. Refer to the official DJI website (<https://www.dji.com/support/compatibility>) for the most updated DJI RSC 2 Camera Compatibility List.

### Mounting a Camera

Make sure to prepare the camera before mounting it to DJI RSC 2. Remove the lens cap and check that the battery and memory card are inserted in the camera. Make sure DJI RSC 2 is powered off or in sleep mode before mounting the camera.

#### 1. Attach the Upper Quick-Release Plate

The camera lens and the arrow on the bottom of the upper quick-release plate must face the same direction. Attach the upper quick-release plate to the camera by tightening the screw.

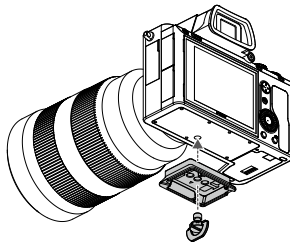

 A camera riser is required when using a focus motor or a small camera with a large lens, such as a Sony A6400 with the Sony FE 24-70 f2.8 GM lens.

## 2. Attach the Lower Quick-Release Plate and Lens Support

Toggle the lever on the lower quick-release plate to the unlocked position ①, insert the camera ②, and toggle the lever to the locked position ③ after it is engaged. Attach the lens support to the lower quick-release plate ④. It is recommended to use the lens support\* when using a long or heavy lens.

To remove the camera from the lower quick-release plate, toggle the lever to the unlocked position and remove the camera while pressing the safety lock beside the lever.

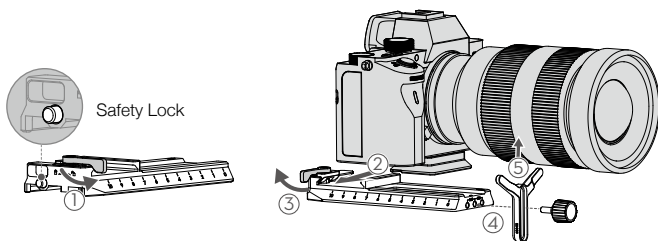

\* The Lens-Fastening Strap (not included) is required to use SuperSmooth mode.

## 3. Attach the Camera to the Gimbal

Toggle the lever on the camera mounting plate to the unlocked position ① and insert the lower quick-release plate ②. Toggle the lever to the locked position once the camera is roughly balanced ③.

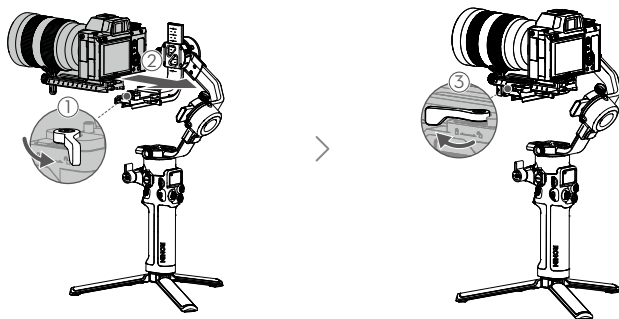

 The position of the camera mounting plate can be adjusted by toggling the lever on the bottom.



To remove the lower quick-release plate from the gimbal, toggle the lever on the camera mounting plate to the unlocked position and remove the lower quick-release plate while pressing the safety lock on the mounting plate.

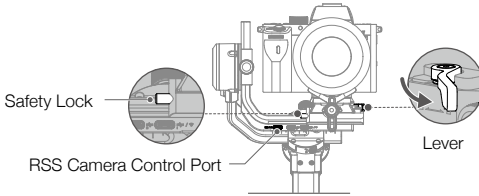

#### 4. Connect the Camera Control Cable

Choose the proper camera control cable according to the camera type. Plug one end of the cable into the camera and plug the other end into the RSS camera control port of the gimbal as shown above.

## Balancing

To obtain the best performance from DJI RSC 2, proper balancing is essential. Proper balance is critical for shots with DJI RSC 2 where fast motion or acceleration is required and also offers longer battery runtimes. There are three axes that need to be properly balanced before powering on DJI RSC 2 and setting up the software.

### Before Balancing

1. The camera needs to be fully configured, with all accessories and cables connected, before installing and balancing the camera on the gimbal. If the camera has a lens cap, make sure to remove it before balancing.
2. Before balancing, make sure to power on the camera if using an optical zoom lens and to select the focal length if using a varifocal lens. Make sure DJI RSC 2 is powered off or in sleep mode before balancing.

### Balancing Steps

#### 1. Balancing the Vertical Tilt

- a. Unlock the tilt axis and loosen the mounting plate knob ①.
- b. Rotate the tilt axis so that the camera lens is pointing upward. Check to make sure the camera is not top or bottom-heavy. If top-heavy, move the camera backward ②. If bottom-heavy, move the camera forward ②.
- c. Tighten the mounting plate knob while holding the camera upward. The vertical tilt is balanced when the camera is steady while pointing upward.

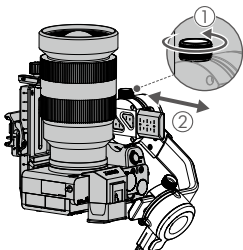

## 2. Balancing Depth for the Tilt Axis

- Rotate the tilt axis so that the camera lens is pointing forward. Toggle the lever to the unlocked position ①.
- Check to make sure the camera is not front or back-heavy. If front-heavy, move the camera backward ②. If back-heavy, move the camera forward ②.
- Toggle the lever to the locked position. The tilt axis is balanced when the camera is steady while tilted up or down by 45°.
- Lock the tilt axis.

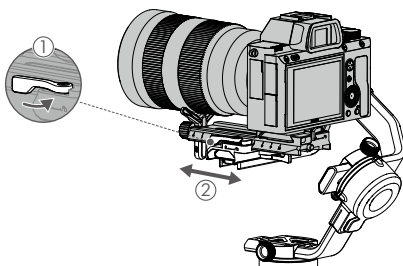

## 3. Balancing the Roll Axis

- Unlock the roll axis. Loosen the knob on the roll arm ①.
- Check the direction in which the roll motor swings. If the camera rotates to the left, move the camera to the right ②. If the camera rotates to the right, move the camera to the left ②.
- Tighten the knob. The roll axis is balanced when the camera is steady.
- Lock the roll axis.

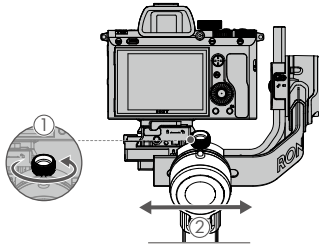

#### 4. Balancing the Pan Axis

- a. Unlock the pan axis. Loosen the knob ①.
- b. While holding the grip, tilt DJI RSC 2 forward, and rotate the pan arm until parallel with you.
- c. Check the movement of the pan axis. If the camera lens rotates to the left, push the pan axis to the right ②. If the camera lens rotates to the right, push the pan axis to the left ②.
- d. Tighten the knob. The pan axis is balanced if the camera is steady when rotating the pan while tilting the grip.

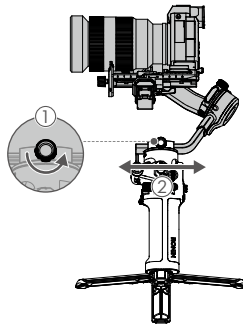

**⚠** If mounting a longer camera system, it is necessary to use counterweights. Visit the official DJI online store to purchase the counterweights.

# Grip and Built-In Battery

The grip is for handheld use. The built-in battery within the grip has a capacity of 3400 mAh and the maximum runtime is 14 hours (when DJI RSC 2 is properly balanced).

## Charging

Before using for the first time, charge DJI RSC 2 through the power port using a charging cable (included) and a USB adapter (not included). It is recommended to use a QC 2.0 or PD USB adapter (max. 18W). Check the battery level on the screen.

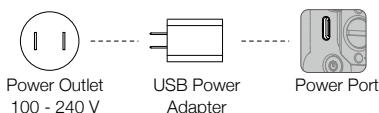

## Safety Guidelines

The following terms are used throughout the product literature to indicate various levels of potential harm when operating this product:

**WARNING** Procedures, which if not properly followed, create the probability of property damage, collateral damage, and serious injury OR create a high probability of superficial injury.

**NOTICE** Procedures, which if not properly followed, create a possibility of physical property damage AND a little or no possibility of injury.



### WARNING

Read the user manual to become familiar with the features of this product before operating. Failure to operate the product correctly can result in damage to the product, personal property, and cause serious injury. This is a sophisticated product. It must be operated with caution and common sense and requires some basic mechanical ability. Failure to operate this product in a safe and responsible manner could result in injury or damage to the product or other property.

This product is not intended for use by children without direct adult supervision. Do not alter this product in any way outside of the documents provided by SZ DJI OSMO TECHNOLOGY CO., LTD. These Safety Guidelines contain instructions for safety, operation and maintenance. It is essential to read and follow all of the instructions and warnings in the user manual, prior to assembly, setup or use, in order to operate the product correctly and avoid damage or serious injury.

**⚠ WARNING**

To avoid fire, serious injury, and property damage, observe the following safety guidelines when using, charging, or storing the grip.

**Grip Use**

1. DO NOT allow the grip to come into contact with any kind of liquid. DO NOT leave the grip out in the rain or near a source of moisture. DO NOT drop the grip into water. If the inside of the battery comes into contact with water, chemical decomposition may occur, potentially resulting in the battery catching on fire, and may even lead to an explosion.
2. If the grip falls into water by accident, put it in a safe and open area immediately. Maintain a safe distance from the grip until it is completely dry. DO NOT use the grip again, and dispose of the grip properly as described in the Grip Disposal section.
3. Put out any fire using water, sand, fire blanket, or a dry powder fire extinguisher.
4. DO NOT use non-DJI batteries. DJI takes no responsibility for any damage caused by non-DJI batteries.
5. DO NOT use or charge a swollen, leaky, or damaged grip. If the grip is abnormal, contact DJI or a DJI authorized dealer for further assistance.
6. The grip should be used in temperatures from  $-20^{\circ}$  to  $45^{\circ}$  C ( $-4^{\circ}$  to  $113^{\circ}$  F). Use of the grip in environments above  $50^{\circ}$  C ( $122^{\circ}$  F) can lead to a fire or explosion. Use of grip below  $-10^{\circ}$  C ( $14^{\circ}$  F) can lead to permanent damage.
7. DO NOT use the grip in strong electrostatic or electromagnetic environments. Otherwise, the battery control board may malfunction.
8. DO NOT disassemble or pierce the grip in any way or the battery may leak, ignite, or explode.
9. DO NOT drop or strike batteries. DO NOT place heavy objects on the grip or charger.
10. Electrolytes in the battery are highly corrosive. If any electrolytes make contact with your skin or eyes, immediately wash the affected area with fresh running water for at least 15 minutes, and then see a doctor immediately.
11. DO NOT use the grip if dropped.
12. DO NOT heat batteries. DO NOT put the grip in a microwave oven or in a pressurized container.
13. DO NOT manually short-circuit the grip.
14. Clean grip terminals with a clean, dry cloth.

**Grip Charging**

1. DO NOT leave the grip unattended during charging. DO NOT charge the grip near flammable materials or on flammable surfaces such as carpet or wood.
2. Charging the grip outside of the temperature range of  $5^{\circ}$  to  $40^{\circ}$  C ( $41^{\circ}$  to  $104^{\circ}$  F) may lead to leakage, overheating, or battery damage. The ideal charging temperature is  $22^{\circ}$  to  $28^{\circ}$  C ( $72^{\circ}$  to  $82^{\circ}$  F).

## Grip Storage

1. Keep the grip out of the reach of children and animals.
2. If the grip will be stored for an extended period, charge the grip until the battery level reaches between 30% and 50%.
3. DO NOT leave the grip near heat sources such as a furnace or heater. DO NOT leave the grip inside of a vehicle on hot days. The ideal storage temperature is 22° to 28° C (72° to 82° F).
4. Keep the grip dry.

## Grip Maintenance

1. DO NOT use the grip when the temperature is too high or too low.
2. DO NOT store the grip in environments with a temperature higher than 45° C (113° F) or lower than 0° C (32° F).

## Travel Notice

1. Before carrying the grip on an airline flight, it must first be discharged until the battery level is lower than 30%. Only discharge the grip in a fireproof location and store the grip in a ventilated location.
2. Keep the grip away from metal objects such as glasses, watches, jewelry, and hairpins.
3. DO NOT transport a damaged grip or a grip with battery level higher than 30%.

## Grip Disposal

Dispose of the grip in specific recycling boxes only after a complete discharge. DO NOT place the grip in regular trash containers. Strictly follow your local regulations regarding the disposal and recycling of batteries.

### **NOTICE**

## Grip Use

1. Make sure the grip is fully charged before use.
2. If a low-battery warning appears, charge the grip as soon as possible.

## Grip Charging

1. The grip is designed to stop charging when it is full. It is good practice, however, to monitor the charging progress and disconnect the gimbal when fully charged.

## Grip Storage

1. Discharge the grip to 40%-65% if it will not be used for 10 days or more. This can greatly extend the battery life.
2. DO NOT store the grip for an extended period after fully discharging. Doing so may over-discharge the battery and cause irreparable damage to the battery cell.
3. If the grip is stored for an extended period and the battery is depleted, the grip will enter sleep mode. Recharge the grip to exit sleep mode.

### Grip Maintenance

1. Battery life may be reduced if not used for an extended period.
2. Discharge and charge the grip completely once every three months to keep it in good condition.

### Grip Disposal

1. If the grip is disabled and the battery cannot be fully discharged, contact a professional battery disposal or recycling agent for further assistance.
2. Dispose of the grip immediately if it cannot be powered on after over-discharging.

# Operations

## Activating DJI RSC 2

DJI RSC 2 needs to be activated through the Ronin app before using for the first time.

1. Press and hold the power button to power on the gimbal.
2. Enable Bluetooth on your mobile device and launch the Ronin app. Once detected in the list of Bluetooth devices, select DJI RSC 2 and input the default Bluetooth password: 12345678. Make sure you are connected to the internet and follow the on-screen instructions to activate DJI RSC 2. Note that a DJI account is required during activation.

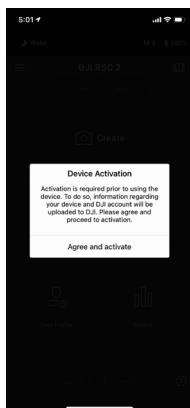

## Screen Operation

Home



**M1** : indicates the current user profile. Users can set and save three user profiles: M1, M2, and M3.

**HD** : indicates the DJI RavenEye Image Transmission System is connected.

**⚡** : indicates Sport mode is enabled.



**📷** : indicates a camera control cable is connected.

**⚡** : indicates the battery is being charged.

**50%** : displays the current battery level of the gimbal.

Press the side dial to enter the menu, turn the side dial to scroll through the options, and press confirm to select. Press the back button to go back to the previous menu.



-  **Auto Tune:** press the side dial to select Auto Tune after balancing the gimbal. If the lens-fastening strap is installed, users can enable SuperSmooth prior to auto tune for optimal performance. SuperSmooth will take effect after auto tune completed. The stiffness can be adjusted on the auto tune screen.
-  **Follow Mode Settings:** tap to select follow mode and speed. The tilt motor controls the tilt axis to follow, pan motor controls the pan axis to follow, and roll motor controls the roll axis to follow.

## Follow Mode

PF: pan follow, where only the pan axis follows the movement of the grip.

PTF: pan and tilt follow, where both the pan and tilt axes follow the movement of the grip.

FPV: pan, tilt, and roll follow, where all three axes follow the movement of the grip.

3D Roll 360: enable to shoot footage while rotating the camera 360°.

Portrait: enable to shoot in portrait mode.

Custom: enable or disable any axis follow as required.

## Follow Speed

Select the follow speed. Users can choose fast, medium, slow, and custom.

 **Joystick Settings:** including Joystick Speed and Smoothing settings.

**Joystick Speed:** allows users to control the speed of the joystick for the gimbal. Users can choose fast, medium, slow, and custom.

**Joystick Smoothing:** allows users to control the sensitivity of the gimbal. The lower the smoothing value, the more sensitive the movement of the gimbal.

 **Front Dial Settings:** including Dial Function and Speed settings.

**Dial Functions:** allows users to set the function of the front dial. Users can choose to control the focus motor, focus, ISO, aperture, and roll axis.

**Dial Speed:** allows users to set the response speed of the function set for the front dial.

## Advanced Settings

**Silent Mode:** enable to turn off sounds including the warning tone.

**Disable Selfie:** prevents accidentally entering selfie mode and interrupting recording. If disabled, Selfie mode will not be entered if the trigger is pressed three times.

**Horiz Calibration:** use if the gimbal is unlevel when the gimbal is steady. If the issue persists, use Tune Manually.

**Gimbal Auto Check:** tap to analyze and output the status information of the gimbal.

**Push Mode:** enable to manually control the tilt and pan axis.

**More:** tap to restore the gimbal parameters and Bluetooth password to default settings, choose the onscreen language from English and Chinese (Simplified), and view the device information and firmware version.

## Button Functions



**Power Button**  
Press and hold to power on or off.  
Tap or press twice to enter or exit sleep mode.



**Joystick**  
Push up or down to control the movement of the tilt axis and left or right to control the movement of the pan axis (default setting).



**Camera Control Button\***  
Press halfway for autofocus.  
Press once to start or stop recording.  
Press and hold to take a photo.



**Front Dial\***  
Turn to control focus (default setting).



**Trigger**  
Tap once to start ActiveTrack (requires the DJI Ronin RavenEye Image Transmission System to be enabled).  
Press and hold to enter Lock mode.  
Tap twice to re-center the gimbal.  
Tap three times to turn the gimbal 180° so that the camera faces you (selfie mode).



**M Button**  
Tap to select a user profile.  
Press and hold to enter Sport mode.  
Press and hold and press the trigger twice to remain in Sport mode. Repeat to exit Sport mode.  
Quickly tap twice to enter portrait mode.  
Press three times to enter or exit 3D Roll 360. When in 3D Roll 360, move the joystick left or right twice to automatically rotate the camera. Tap the trigger twice to stop continuous auto rotation.  
Press and hold the M button together with the trigger to begin auto tune.

\* The camera control cable must be connected in order to use the functions of the camera control button and front dial. Note that these functions will vary according to the camera. Refer to the DJI RSC 2 Camera Compatibility List on [www.dji.com/rsc-2](http://www.dji.com/rsc-2) for more information.

## Ports

NATO ports can be used to attach a Briefcase Handle and Twist Grip Dual Handle.

## Ronin App Settings

The Ronin App is easy to use to control gimbal movement and parameter settings with intelligent functions such as Panorama, Timelapse, and Track, as well as more features of the gimbal and the DJI Ronin RavenEye Image Transmission System. The screenshots below are based on the iOS version of the app.

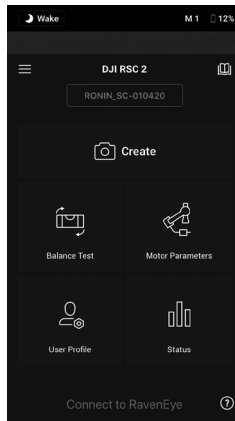

### Top Bar

**Sleep/Wake:** tap to enter or exit sleep mode. When DJI RSC 2 is in sleep mode, the motor will be powered off, but the gimbal remains powered on.

**M1:** displays the current user profile.

**Battery Level:** displays the battery level of the gimbal.

### ☰ About

**Settings:** view your account and the quick start guide.

**Device List:** displays the device name and password.

**Firmware:** displays the firmware version.

### 📖 Academy

Watch the tutorials and read the manual documents.

## Create

## Virtual Joystick

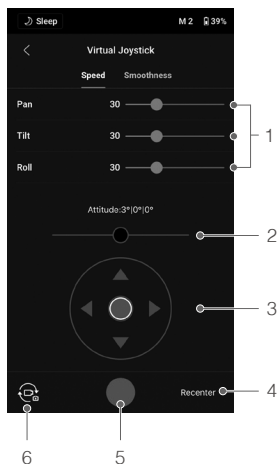

Use the virtual joystick in the app to control the movement of the gimbal and to shoot.

1. Control Bar: control the speed and smoothness of the gimbal by adjusting the control bar. Speed allows users to adjust the remote-controlled rotational speed. Smoothness allows users to adjust the sensitivity of the gimbal. The lower the smoothing value, the more sensitive the movement of the gimbal.
2. Roll Stick: control the roll axis movement of the gimbal using the virtual joystick.
3. Pan/Tilt Stick: control the pan and tilt axis movement of the gimbal using the virtual joystick.
4. Recenter: tap to recenter the gimbal.
5. Shoot/Record Button: tap to take photos or record videos.
6. Photo/Video Toggle: tap to switch between photo and video modes. Make sure the mode is the same as the settings on the camera.

## Force Mobile

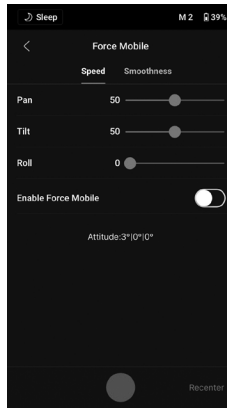

Force Mobile requires the phone holder and a mobile phone mounted on a tripod or handlebar vertically. After enabling this feature in the Ronin app, the gimbal movement can be controlled by tilting and rotating your mobile phone.

Speed determines the relationship between the rotational speed and angle. When the speed is set to 50, the angle of rotation for the gimbal and mobile phone is 1-to-1. The gimbal will move at an identical angle to the mobile phone. When the speed is set to less than 50, the gimbal will rotate slower than the movement of the phone. When the max speed is set higher to a higher value than 50, the rotation of the gimbal is faster than the mobile phone.

Smoothing allows users to control the sensitivity of the gimbal. The lower the smoothing value, the more sensitive the movement of the gimbal.

Recenter: tap to recenter the gimbal.

Shutter/Record Button: tap to take photos or record videos.

## Panorama

Panorama allows users to capture a series of interconnecting still images with precise control based on the sensor type, lens focal length, overlap, and interval.

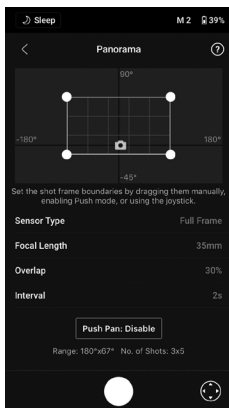

Make sure you have connected the camera and gimbal using the corresponding camera control cable before using Panorama.

**Overlap:** determines the overlap ratio of every photo when generating a panorama.

The interval time between shooting photos should be set to one second more than the shutter time to avoid blurred footage when using a long exposure.

After confirming the camera settings, the panorama range can be set by dragging the white dots on the grid map, pushing the gimbal manually, or using the virtual joystick. The total range covered by the endpoints and the shots required to compose the panorama is displayed above the grid map. The tilt axis range in Panorama is  $-45^{\circ}$  to  $+90^{\circ}$  in order to avoid capturing the gimbal in the shot, while the pan axis allows you to capture a full  $360^{\circ}$  rotation.

Tap the shutter/record button to begin.

## Timelapse

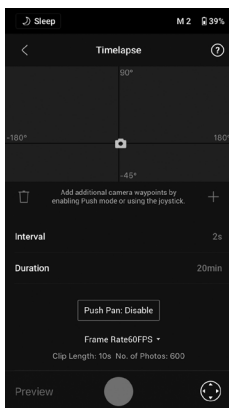

In Timelapse, DJI RSC 2 triggers the camera to capture still images with the set interval time and will automatically stop when completed. The duration for the Timelapse and the frame rate can be set so that DJI RSC 2 can calculate the exact number of images required.

By enabling Push mode, users can manually adjust the pan and tilt axes before starting the Timelapse. Users can push DJI RSC 2 to alter the camera orientation and adjust the framing. Tap the virtual joystick icon to use the virtual joystick to adjust the camera orientation.

Motionlapse allows users to set up to five waypoints so that the camera moves during the Timelapse.

To adjust the position of a waypoint, adjust the camera to the desired position, and tap the + icon to confirm the waypoint. You can also use the virtual joystick to control the pan, tilt, and roll axis as well.

To add another waypoint, move the gimbal to the next waypoint, and tap the + icon above the grid map. Afterwards, to delete a waypoint, select the waypoint and tap the trash icon.

After setting up the waypoints, you can either tap Preview to make sure the Motionlapse includes everything or tap the shutter/record button to start shooting. Make sure the camera and gimbal have been connected using the corresponding camera control cable.

## Track

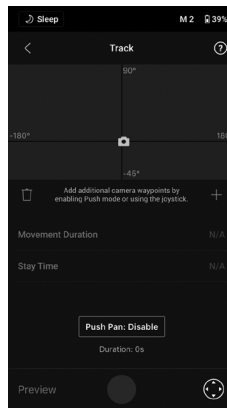

Track is designed to capture video with up to 10 waypoints. Users need to select the waypoint manually by moving the gimbal or using the virtual joystick. The duration parameter below the grid map indicates how much time it will take for the gimbal to travel from one waypoint to the next. The stay time indicates how long the gimbal will remain steady at the waypoint before moving to the next waypoint.

---

**⚠** DO NOT press the shutter button of the camera while using Track.

---

## Gaming Controller

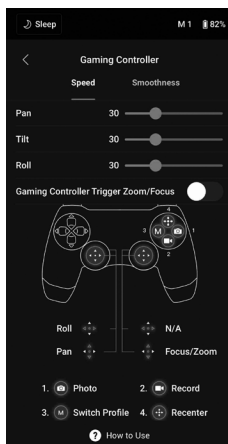

PS4 DualShock and Xbox controllers can be used to control the gimbal and camera. After connecting the controller to the mobile device and gimbal, users can control gimbal movements, focus and zoom, and can record videos, recenter gimbal, capture photos, and switch profiles.

The speed and smoothness of the control sticks can be adjusted. Set the focus value within 10 on the camera settings for optimal performance. iOS 13 or higher, Android 9.0 or higher, and Ronin app v1.4.0 or higher are required.

Tap How to Use to learn more about the gaming controller.

## Balance Adjustment

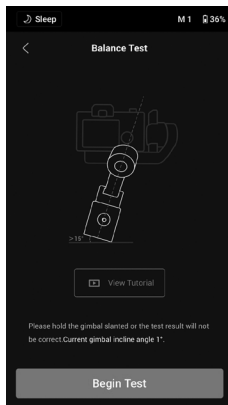

Tap Begin Test and DJI RSC 2 will check the balance status and provide a score for each axis. Make sure the gimbal is not obstructed in any way before performing the balance test and follow the onscreen instructions.



## Motor Parameters

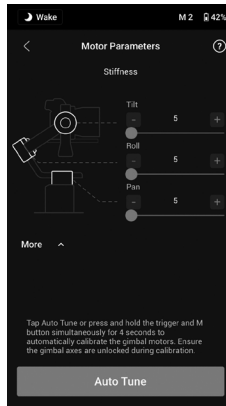

Auto Tune: the stiffness value is determined by the payload of the gimbal. Use Auto Tune to obtain the stiffness value automatically after balancing.

Tap Auto Tune and DJI RSC 2 automatically calculates the result based on the weight of the gimbal setup. Alternatively, press and hold the M button and trigger simultaneously for four seconds to start auto tune without using the app.

The auto tune process takes approximately 15 to 30 seconds. After auto tune, you can see detailed motor diagnostics at the bottom of the screen. If the gimbal is properly balanced, the power value of the motors should be in the range of  $\pm 5$ . If power consumption on a particular axis constantly goes beyond that range, check the mechanical balance of DJI RSC 2.

Stiffness: the motor stiffness adjustment allows you to fine-tune the power that is applied by the motors as they react and balance the weight on each axis. Make sure you leave an extra margin to ensure stability at all times. If the stiffness value is too high the gimbal may shake and if the value is too low the gimbal performance will be affected.



- When using auto tune, make sure the three axes are unlocked, and that DJI RSC 2 is placed on a steady surface in Upright or Underslung mode.
  - Make sure the gimbal is balanced and the stiffness values are tuned properly every time you change the camera or lens.
-

## User Profile

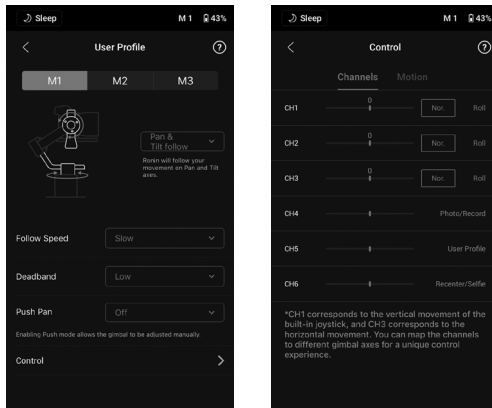

Three user profiles can be set and saved.

Choose from Pan and Tilt Follow, FPV, Customized, and 3D Roll 360.

Speed: determines how fast the camera travels while translating a pan, tilt, or roll movement.

Deadband: determines how much movement the gimbal tolerates prior to translating the pan, tilt, and roll movement of the camera.

Push: after enabling Push, the gimbal axis can be manually pushed to the desired position.

## Control Settings

### Channels

The channel indicator provides feedback when configuring remote operation. Pan, tilt, and roll channels can be reassigned and each axis can also be inverted. Normal means the direction of movement is the same as the joystick. Inverted means the direction of movement is the opposite of the joystick.

When using the joystick, you can only control CH1 and CH3, which is mapped to tilt and pan axes by default. You can customize channel mapping by tapping on the name of the axis on the right of the screen.

### Motion

You can set the joystick control by adjusting deadband, max speed, smoothing, and endpoints for each axis. There are three default profiles for each settings.

Deadband: when the deadband value increases, more stick movement will be required to translate into the actual movement of the gimbal.

Max Speed: allows the remote-controlled rotational speed to be adjusted.

Smoothing: allows you to control the sensitivity of the gimbal. The lower the smoothing value, the more sensitive the movement of the gimbal.

Endpoint: limits the rotational range of the gimbal by setting the endpoints. The pan axis has a slip-ring, enabling DJI RSC 2 to rotate continuously when the endpoints are set to 180°. On the tilt axis, you can set up the endpoints according to your requirements. Some longer lenses may hit the gimbal frame. Set the endpoint angle to prevent such cases.

## Status

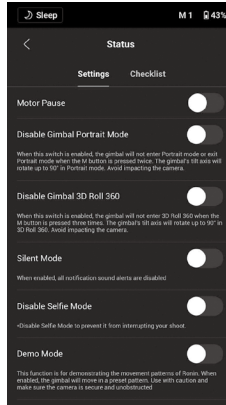

## Settings

Use more features such as Motor Pause, Disable Gimbal Portrait Mode, Silent Mode, System Calibration, Advanced Calibration, and Restore Gimbal Setup.

## Checklist

When the gimbal status is abnormal, the status information is displayed here.

## Image Transmission

With the DJI Ronin RavenEye Image Transmission System mounted, tap Connect to RavenEye on the home screen of the Ronin app to use the image transmission feature.

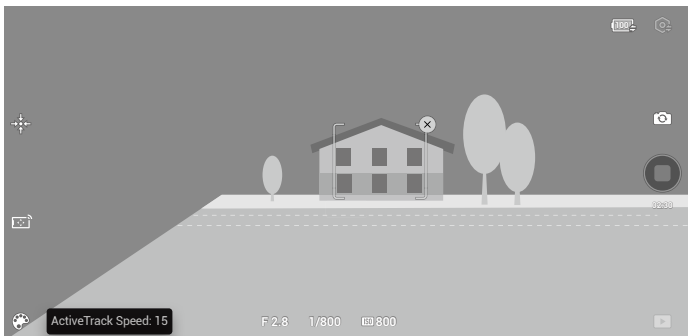

### Using ActiveTrack 3.0

When tracking a person, it is recommended to select and confirm the person in the center of the camera view by pressing the trigger once. When tracking an object, it is recommended to select and confirm the object by dragging a box around it in order to recognize the object better. The gimbal begins to track after recognizing the object successfully.

The appropriate speed should be set when using ActiveTrack. Subjects may be lost if the speed is set too high and the stabilization may be affected if the speed is set too low.

For optimal performance, it is recommended to set the ActiveTrack speed to 20 when using a lens with a 24 mm equivalent focal length (tested with Sony  $\alpha 7$  III). Increase the ActiveTrack speed when using a lens with an equivalent focal length less than 24 mm. Decrease the ActiveTrack speed when using a lens with an equivalent focal length more than 24 mm.

Tap  to use Virtual Joystick and Force Mobile.

---

 Refer to the DJI Ronin RavenEye Image Transmission System User Guide for more information.

---

## Operation Modes

There are four operation modes for DJI RSC 2: Upright, Underslung, Flashlight, and Briefcase.

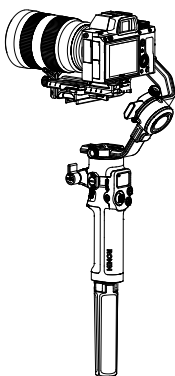

Upright Mode

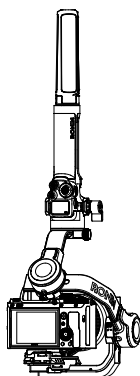

Underslung Mode

**Upright mode:** Upright mode is enabled after powering on the gimbal.

**Underslung mode:** enter sleep mode when the gimbal is in Upright mode and turn DJI RSC 2 upside down and rotate the roll axis 180°. Underslung mode is enabled after DJI RSC 2 exits from sleep mode.

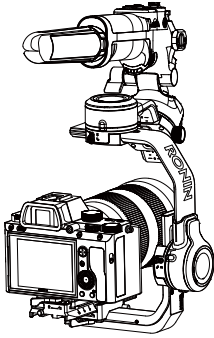

Briefcase Mode

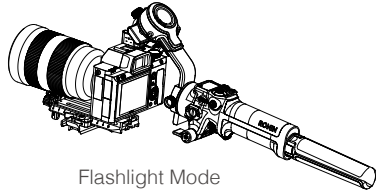

Flashlight Mode

**Briefcase mode:** when DJI RSC 2 is powered on and working in Upright mode, loosen the lock knob of the gimbal, adjust to the lower position, and tighten the lock knob. Briefcase mode is enabled after pressing the trigger twice. When DJI RSC 2 is powered off, loosen the lock knob of the gimbal, adjust to the lower position, and tighten the lock knob. Briefcase mode is enabled after powering on the gimbal.

**Flashlight mode:** Flashlight mode is enabled after tilting the gimbal forward 90° from Upright mode.

3D Roll 360 is available when using DJI RSC 2 in Flashlight mode. The slip-ring on the pan axis enables DJI RSC 2 to perform a continuous roll rotation.

Press the M button three times to enter or exit 3D Roll 360 or go to User Profile in the Ronin app to enable or disable 3D Roll 360. Push the joystick to the left or right to begin 3D Roll 360. Push the joystick to the left or right twice in quick succession to trigger auto rotation.

**During auto rotation:** when the grip is horizontal, press the trigger twice and the camera will stop in an upright position. Press the trigger three times and the camera will stop in an upside-down position. When the grip is vertical, press the trigger twice and the camera will stop at a pan axis angle of 0° with the lens pointing upward. Press the trigger three times and the camera will stop at a pan axis angle of 180° degree with lens pointing upward.

Set the Max Speed and Smoothing for the 3D Roll 360 in the Control settings under the User Profile of the Ronin app. Note that Speed and Deadband are unavailable when using 3D Roll 360.

## Updating Firmware

Update the firmware using the Ronin app. An on-screen alert will be received when new firmware is available. Follow the on-screen instructions to update the firmware.

## Maintenance

DJI RSC 2 is not waterproof. Make sure to protect it from dust and water during use. After use, it is recommended to wipe DJI RSC 2 with a soft dry cloth. DO NOT spray any cleaning liquids onto DJI RSC 2.

## Specifications

External Device	Accessory Port	NATO ports M4 Mounting Holes 1/4"-20 Mounting Holes Cold Shoe Mount Video Transmission/ Follow Focus Motor Port (USB-C) RSS Camera Control Port (USB-C) Follow Focus Motor Port (USB-C)
	Input Power	Model: RB2-3400mAh -7.2 V Type: 18650 2S Capacity: 3400 mAh Energy: 24.48 Wh Max Runtime: Approx. 14 hours Charging Time: Approx. 2 hours (tested with 18W fast charging, PD and QC 2.0 fast charging protocols are supported) Charging temperature: 5° to 40° C (41° to 104° F)
	Connections	Bluetooth 5.0; USB-C
	Ronin App Requirements	iOS 11.0 or above Android 7.0 or above
Working Performance	Load Weight (Reference Value)	3 kg (Handheld)
	Maximum Controlled Rotation Speed	Pan axis: 360°/s Tilt axis: 360°/s Roll axis: 360°/s
	Mechanical Endpoint Range	Pan axis: 360° continuous rotation Roll axis: -240° to +95° Tilt axis: -112° to +214°
Mechanical and Electrical Characteristics	Bluetooth Operating Frequency	2.40 - 2.4835 GHz
	Bluetooth Transmitter Power	<8 dBm
	Operating Temperature	-20° to 45° C (-4° to 113° F)

Mechanical and Electrical Characteristics	Weight	Gimbal: Approx. 1.20 kg (excl. quick-release plate) Quick-Release Plate: Approx. 100 g Extended Grip/Tripod (metal): Approx. 220 g Extended Grip/Tripod (plastic): Approx. 160 g
	Dimensions	Gimbal (folded): 260 × 210 × 75 mm (excl. grip) Gimbal (unfolded): 400 × 185 × 175 mm (incl. grip, excl. Extended Grip/Tripod)

This content is subject to change.

Download the latest version from  
<http://www.dji.com/rsc-2>

If you have any questions about this document, please contact DJI by sending a message to [DocSupport@dji.com](mailto:DocSupport@dji.com).

RONIN is a trademark of DJI OSMO.  
Copyright © 2020 DJI OSMO All Rights Reserved.